



FIRE NOC

CITIZEN MANUAL (G2C)

(नागरिकों के लिये)

Instructions to fill Online Application ऑनलाइन आवेदन भरने के निर्देश

Open web page <https://sso.rajabsthan.gov.in/signin> वेबपेज खोलें

Enter your SSO ID and PASSWORD. Enter CAPTCHA from given image. Then click on LOGIN
अपना एसएसओ आईडी और पासवर्ड डाले. दी गयी इमेज से कैप्चा दर्ज करे उसके बाद लॉगिन पर क्लिक करें .

After login click on Citizen apps (G2C) / लॉगिन के बाद सिटीजन एप्स (G2C) पर क्लिक करें

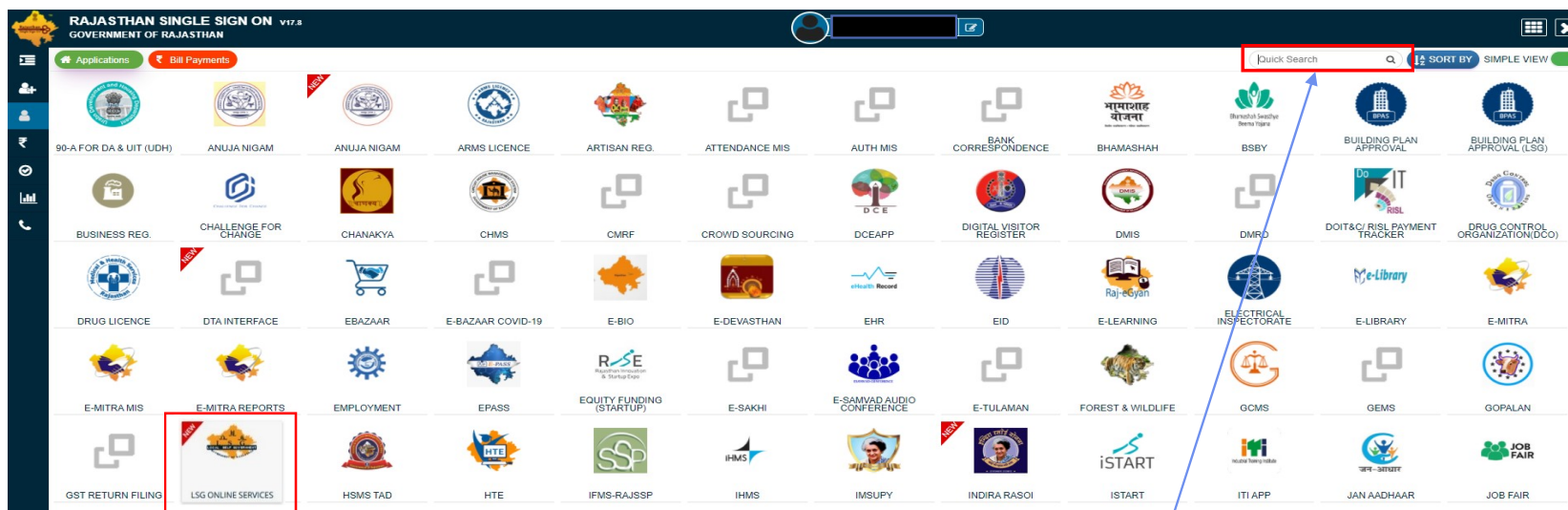

Click on “**LSG ONLINE SERVICES**” पर क्लिक करें

If you are having trouble in finding the application you can use the **Quick Search option**. Type Application name in Quick Search as shown below/ एप्लिकेशन को सर्च करने के लिये क्विक सर्च ऑप्शन का भी प्रयोग किया जा सकता है। नीचे दिये अनुसार एप्लिकेशन का नाम लिखें।

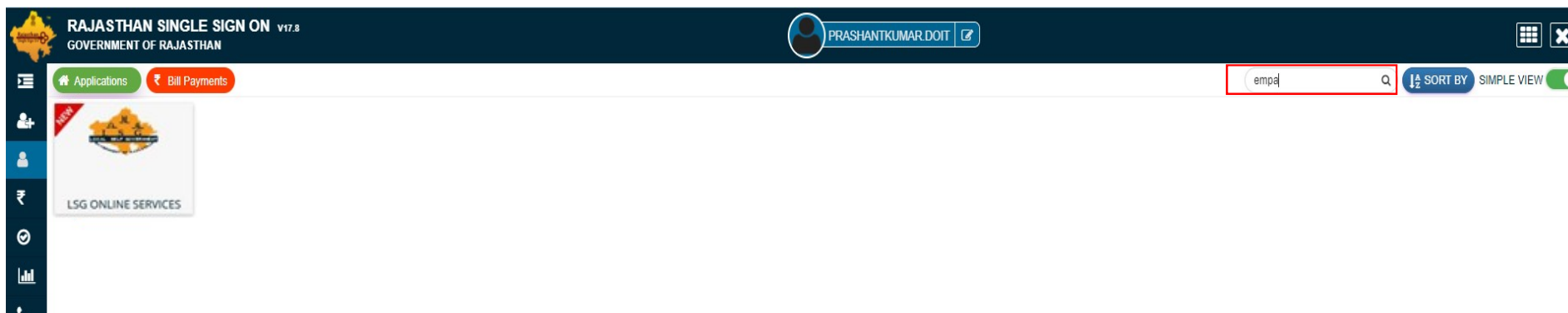

You will be redirected to **LSG Online Our Service Page**, you can see Our Other Services with Fire NOC here./ यह आपको एलएसजी ऑनलाइन अवर सर्विस पेज पर ले जायेगा। जहां आप हमारी फायर एन.ओ.सी के साथ अन्य सेवाओं को भी देख सकते हैं।

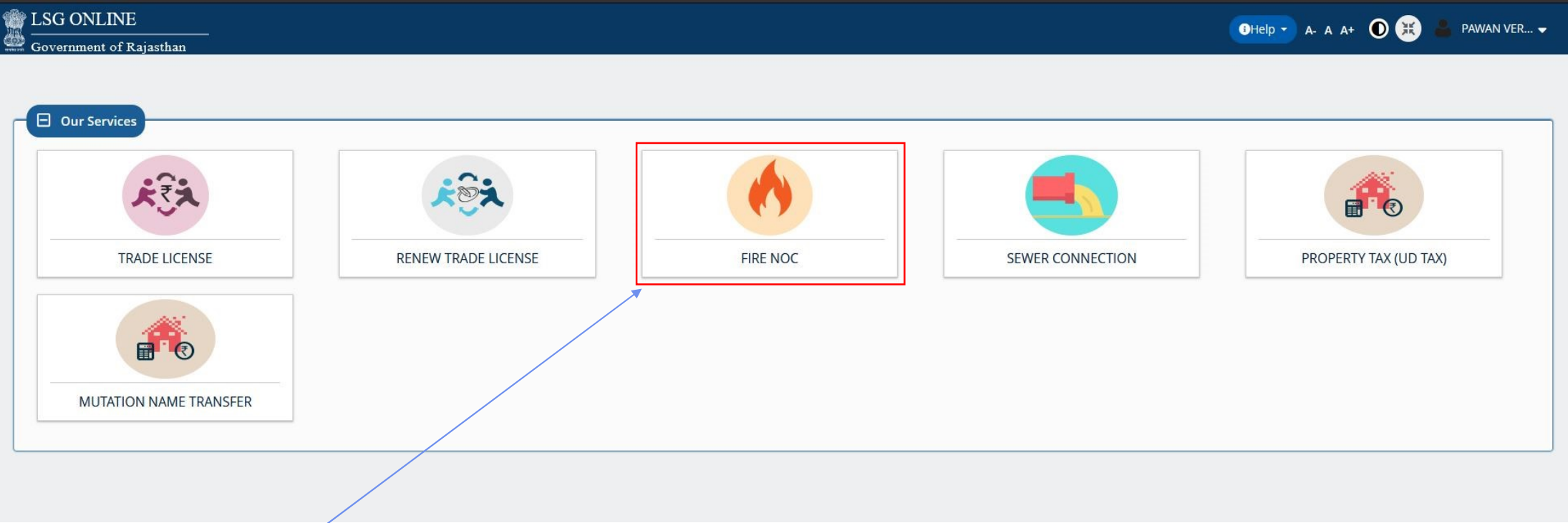

Click On **Fire NOC** to Apply for New Fire NOC./ नए फायर एन.ओ.सी की एप्लीकेशन के लिए फायर एन.ओ.सी पर क्लिक करें।

You can see your active applications here and edit it till final Submit / यहां पर आवेदक द्वारा किये गये सभी आवेदन देख सकते हैं व आखरी सबमिट करने तक संपादित कर सकते हैं।

The screenshot shows the 'FIRE NOC' Applicant Dashboard. The header includes the logo, 'LSG Online, GoR', and user information 'TEST7 USER'. The main content area is titled 'APPLICANT DASHBOARD'. On the left, a sidebar contains three icons: a list icon (labeled 'To check Options'), a dashboard icon (labeled 'Dashboard'), and a plus icon (labeled 'New Fire NOC'). On the right, there are two buttons: 'Renew Fire NOC' and 'Fire NOC Registration' (highlighted with a red box). Below these is a table with columns: S.NO., APPLICATION NO, SUBMITTED ON, NAME, CONTACT NO, ULB, ZONE, STATUS, and Action. The table is currently empty, showing 'No Applications Found'. At the bottom, it says 'You are viewing Page 1 of 1 & Rows 0 - 0 of 0'. There are also links for 'Application View' and 'Application Edit'.

To check Options

Dashboard

New Fire NOC

Renew Fire NOC

Fire NOC Registration

Search...

S.NO.	APPLICATION NO	SUBMITTED ON	NAME	CONTACT NO	ULB	ZONE	STATUS	Action
No Applications Found								

You are viewing Page 1 of 1 & Rows 0 - 0 of 0

Symbol: [Application View](#) [Application Edit](#)

Click on **New NOC** to submit application for New Fire NOC./ नये एन.ओ.सी के आवेदन के लिये न्यू एन.ओ.सी पर के ऑप्शन पर क्लिक करें।

This Page is Applicant Details Three options are provided in Applicant Details / यह पेज आवेदक के विवरण के लिए है आवेदक को तीन ऑप्शन दिये गये हैं । – 1.District / जिला 2.ULB/ यूएलबी 3.Zone/ जोन

Fire NOC
Government of Rajasthan

Help A- A A+ PAWAN VER...

Applicant/NOC Details Building Details Fire Hose Reel Details Other Details Document Upload

District/ULB Details

District* --Select District-- ULB* Zone*

* Mark Fields are Mandatory / जिन फिल्ड्स पर * का चिन्ह है उन्हें भरना जरूरी है।

In this Section Applicant have to share general details for NOC. After Fill all details Click on Save button to save details and Next button to go on next page. इस भाग में आवेदक अपनी सभी जानकारी भर कर सेव बटन पर क्लिक करेगा। व अगले पेज पर जाने के लिए नेक्ट बटन पर क्लिक करेगा

Applicant Details

First Name *

TEST7

Father's Name *

Email *

Last Name *

Mobile No. *

Address *

NOC Details

Category Name *

--Select Category--

Type of NOC *

☐ Temporary

☐ Permanent

Plot Area(In Square Meter) *

Save

Next

Applicant get Data Saved PopUp while click on save button now click on **OK** to next./ आवेदक को सेव बटन पर क्लिक करने के बाद डाटा सेव का पॉपअप आता है। व ओके पर क्लिक करके आगे बढ़ना होता है।

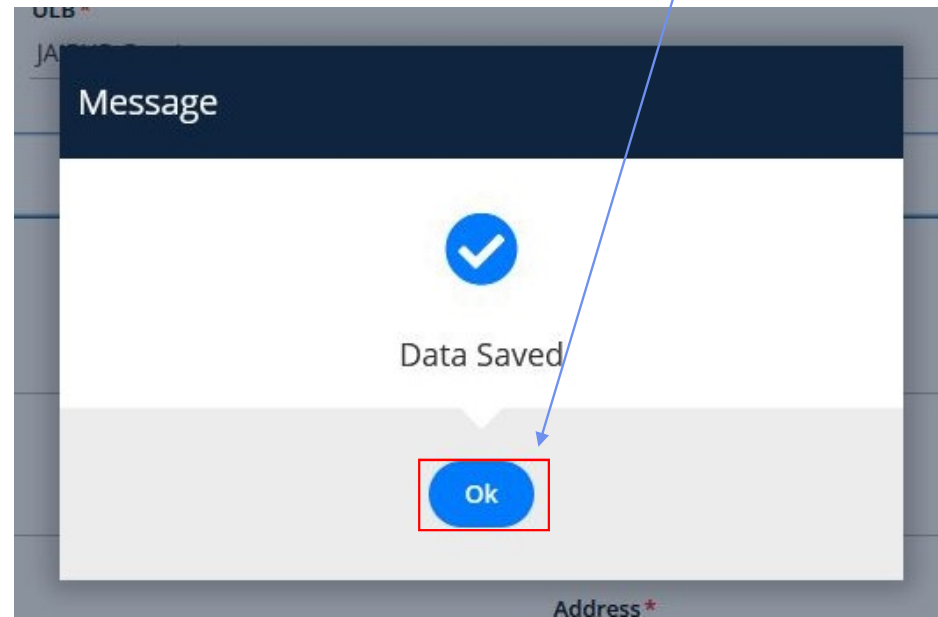

Applicant have to fill all the mandatory fields / आवेदक द्वारा सभी आवश्यक फ़ील्ड्स को भरना आवश्यक है।

☰ Building Detail

Building Name *	Building No. *
Lane/ Street *	Locality *
State * Rajasthan	District * --Select District--
City *	Builder/ Promoter Name
Purpose/ Use of Building * --Select--	Category of Building *
Gross Build Up Area (Sq mt) *	Gross Build Up Area (Sq. ft.) *
Plinth Area(In Meter)	Height of the building(in mt.) *

Overall height (from ground level in mt.)	Number of floors (including ground floor)
BAR Height*	Water supply available exclusively for fire fighting* <input type="checkbox"/> Over Head Water Tank <input type="checkbox"/> Under Ground Water Tank
Has Wet riser(s) been provided? <input type="radio"/> Yes <input checked="" type="radio"/> No	Number of Wet risers
Wet riser Diameter <input type="radio"/> 100 MM <input type="radio"/> 150 MM	Has Dry riser(s) been provided? <input type="radio"/> Yes <input checked="" type="radio"/> No
Dry riser Details	Has any down comer been provided? <input type="radio"/> Yes <input checked="" type="radio"/> No
Down comer Details	Whether any water store available? <input type="radio"/> Yes <input checked="" type="radio"/> No
Water quantity available at Store(in Kilo Liter)	Distance from Store(In Metre)

Previous

Save

Next

After Fill All the details Click on **Save** & **Next** Button And Click on **Previous** Button To Go on Dashboard / सभी जानकारी भरने के पश्चात सेव और नेक्सट बटन पर क्लिक करे व पिछले पेज पर वापस जाने के लिए प्रिवियस बटन पर क्लिक करे।

Applicant have to fill details related to Fire Hose Reel./ यहां आवेदक को फायर हॉज रील की सभी विवरण भरनी है।

Fire Hose Reel Details

Has internal hydrant been provided?

☐ Yes ☒ No

Have first aid-hose reels been provided?

☐ Yes ☒ No

Length of hose-reel

☐ 15 Meter ☐ 30 Meter

Type of nozzle fitted to hose-reel

☐ Hand Controlled ☐ Non Hand Controlled

Has fire hose been provided near each hydrant?

☐ Yes ☒ No

The length of each hose(in Meter)

Have branch pipes been provided?

☐ Yes ☐ No ☒ NA

Size of nozzle fitted to Branch Pipe(in MM)

Water quantity available at Store(in Kilo Liter)

Number of hose reels

Size of nozzle fitted to hose-reel(In MM)

Is the hose reel connected directly to the riser or to the hydrant outlet?

☐ Yes ☒ No

Type of hose

☐ Lined ☐ UnLined

Total number of hoses provided

Type of Branch Pipe

Has it been sprinkled?

☐ Yes ☒ No

Save

Click on **Save** button to save data ./ सेव करने के लिए सेव बटन पर क्लिक करें।

Applicant have to fill all the details of currently using fire fighting system here / आवेदक को यहा वर्तमान में कार्य कर रहे फायर फाइटिंग सिस्टम की जानकारी भरनी है।

System Details

Is the building equipped with automatic fire detection and alarm system?

Yes

No

NA

Code to which the installation confirms

Have manual call boxes been installed in the building for raising a alarm in the event of an outbreak of fire?

Yes

No

NA

Has public address system been provided between the various floors and the fire control room in entrance lobby?

Yes

No

NA

Has a fire control room be provided in entrance lobby of the building?

Yes

No

NA

Width of the stairway(In Inch) *

Height of the riser (in Meter) *

What is the average occupant load per floor?

The floors between which the lift runs

Fire resistance rating of lift car and landing doors, if known

Loading capacity of the lift car(In Person)

Has communication system been installed in the lift for car?

Yes

No

Type of detectors used

Standard to which the detectors confirm

Manual call boxes details

Has an intercom system been provided between the various floors and the fire control room in entrance of the building?

Yes

No

NA

How many staircases Unit have been provided in the building?

Width of the treads(In Inch) *

If the treads are of the non-slip type ?

Yes

No

How many lifts have been installed in the building?

The type of doors fitted to the lift car and at each landing

Floor area of the lift car(In Square Meter)

Loading capacity of the lift car(In Kg)

Has a fireman's switch been installed in the lift for grounding it in the event of fire?

Yes

No

Applicant have to fill Details regarding details Structure of Building Plan. / आवेदक को यहा बिल्डिंग का विशेष विवरण भरना है।

Building Details

Have any stationary fire pump(s) been installed for pressurizing the wet riser?

Yes

No

NA

Number of Main pumps

Number of Joky pumps

Number of Diesel/Generator pumps

The maximum head against which the pump can operate at the output

Has a standby source of power supply been provided?

Yes

No

NA

The function that can be maintained simultaneously by the use of generator, such as operating life(s) fire pumps emergency lighting etc.

Yes

No

NA

Has any yard hydrant been provided form the building's fire pump?

Yes

No

NA

Has the lift shaft(s) lift lobby or stairwell been pressurized?

Yes

No

NA

Have the lift lobbies and staircase been effectively enclosed to prevent fire/smoke entering them from outside at any floor?

Yes

No

NA

Size of suction and delivery connection of each pump

100 MM

150 MM

The output of Main pump(LPM)

The output of Joky pump(LPM)

The output of Diesel/Generator pump(LPM)

Is the pump automatic in action?

Yes

No

Total Pumps Capacity(In LPM/HP)

Is the generator automatic in action or has to be started manually?

Yes

No

NA

Where more than one lifts are installed in a common enclosure have individual lift been separated by fire resisting walls or 2 hours fire ratting?

Yes

No

NA

Lift lobby details

Have all exits and direction of travel to each exit been sign-posted with illuminated signs?

Yes

No

NA

To Be Continued

<p>Has a false ceiling been provided in any protection of the building?</p> <p><input type="radio"/> Yes <input type="radio"/> No <input checked="" type="radio"/> NA</p>	<p>If so, please indicate location false Ceiling Material Type</p> <hr/>
<p>Material used for the false ceiling is combustible or non-combustible</p> <p><input type="radio"/> Yes <input checked="" type="radio"/> No</p>	<p>Is the building centrally air conditioned?</p> <p><input type="radio"/> Yes <input type="radio"/> No <input checked="" type="radio"/> NA</p>
<p>Material used for construction of duct and its fittings</p> <hr/>	<p>Type of tinning use for duct</p> <hr/>
<p>Type of lagging used</p> <hr/>	<p>If any for insulating any portion of the duct, please also indicate how the lagging is secured</p> <hr/>
<p>False ceiling details</p> <hr/>	<p>Has a separate AHU been provided for each floor?</p> <p><input type="radio"/> Yes <input checked="" type="radio"/> No</p> <hr/>
<p>If plenum is used a return air passage has it been protected with fire detectors?</p> <p><input type="radio"/> Yes <input checked="" type="radio"/> No</p>	

After fill the details click in Save button and save data./ सेव करने के लिए सेव बटन पर क्लिक करें।

Applicant have to fill details about the Fire Extinguisher / आवेदक को यहां पर आग बुझाने के यंत्र की सभी विवरण भरने होते है ।

Fire Extinguishing Details

Where are the switchgear and transformers located?

☐ Yes ☐ No ☒ NA

What precautions have been taken to prevent a possible fire in the transformer(s) from spreading?

Please indicate the number of fire extinguishers provided?

Please indicate the arrangement for the maintenance of the extinguishers

Whether the refuge area has been provided?

☐ Yes ☐ No ☒ NA

Does an emergency exist in the building?

☐ Yes ☐ No ☒ NA

Has the building been protected against lightening?

☐ Yes ☐ No ☒ NA

Are the occupants of the building systematically trained in fire prevention?

☐ Yes ☐ No ☒ NA

If the switchgear and transformer(s) have been housed in separate compartments, effectively separated from each other and from other portion of the building by a four hours fire resistive wall?

☐ Yes ☐ No ☒ NA

Whether electric cables, telephone cables, dry/wet risers/down comers pass through a floor or wall have the spaces(apertures) round the cables/pipes been effectively sealed/plugged with non-combustible, fire resistant material?

☐ Yes ☐ No ☒ NA

Please indicate the type of fire extinguishers provided?

Please indicate if all fire extinguishers bear the ISI certification mark

Refuge area details

Emergency Exit details

Does the lightening protect confirm to any code? Please indicate

Has a qualified fire officer been appointed for the building either individually or jointly with other building(s)

☐ Yes ☐ No ☒ NA

Please Upload All Related Documents Here in .pdf format PDF size not exceeded MB./ नीचे दिये अनुसार सम्बंधित सभी दस्तावेज यहां पीडीएफ फॉर्मेट में अपलोड करें । पीडीएफ की साइज 2 एमबी से ज्यादा ना हो।

Applicant &
NOC Detail

Building
Details

Fire Hose
Reel Details

Other
Details

Document
Upload

Document Upload

Note: Valid File Types: PDF except the Building/ Plot Photo(JPEG),Max. File Size: 2MB per attachment. To Upload the File, first browse file then click upload button.
नोट: मान्य फ़ाइल प्रकार: भवन/ प्लॉट फोटो(JPEG) को छोड़कर PDF,अधिकतम फ़ाइल का आकार: प्रति अनुलग्नक 2MB। फ़ाइल अपलोड करने के लिए, पहले फ़ाइल ब्राउज़ करें फिर अपलोड बटन पर क्लिक करें।

ID Proof issued by Government (Aadhaar/Driving Licence/Passport/Bhamashah etc.)*
Select File

Building / Plot Photo*
Select File

Affidavit*
Select File

Ownership Document
Select File

Fire Plan
Select File

UD Tax Receipt
Select File

Previous

Finish

After Fill All the details Click on **Finish** Button And Click on **Previous** Button To Go on Dashboard / सभी जानकारी भरने के पश्चात फिनिश बटन पर क्लिक करे व पिछले पेज पर वापस जाने के लिए प्रिवियस बटन पर क्लिक करे।

After Successful Submission of Application Applicant have to pay Fee For NOC Which have to options Online and Offline Payments options Click on **NO** to pay fee Online and **Yes** if you want to pay through challan ./ आवेदक को एन.ओ.सी के लिए फीस जमा कराने के लिए दो तरीके दिए गये है ऑफलाइन व ऑनलाइन। ऑनलाइन पेमेंट के लिए नो पर क्लिक करे व यस पर क्लिक करे यदि आनलाइन पेमेंट करे।

Offline Payment Details

Any Offline form submission fees paid? *

☐ Yes ☒ No

Pay Online

Close

Offline Payment Details

Any Offline form submission fees paid? *

☒ Yes ☐ No

Challan No. *

Amount *

Challan Copy *
Select File

Deposit Date *

Save Offline Payment

Close

After click on yes button Payment Application forwarded to Accounts to verify./ यस बटन पर क्लिक करने के बाद आवेदन अकाउंट्स में सत्यापन के लिए जाएगा ।

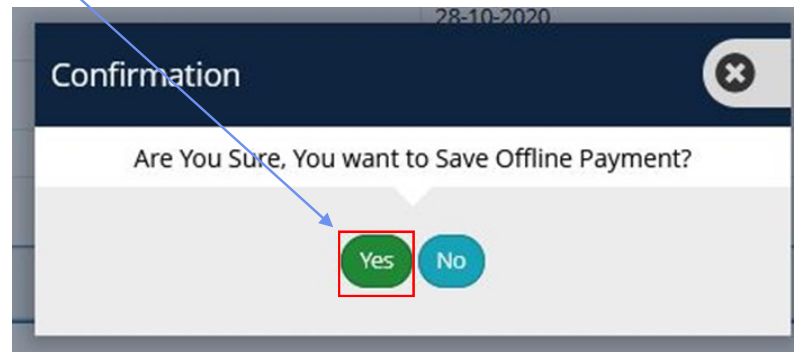

Applicant Click on Download button to click **NOC certificate**./ आवेदक डाउनलोड बटन पर क्लिक करके एन.ओ.सी प्रमाण पत्र प्राप्त कर सकता है।

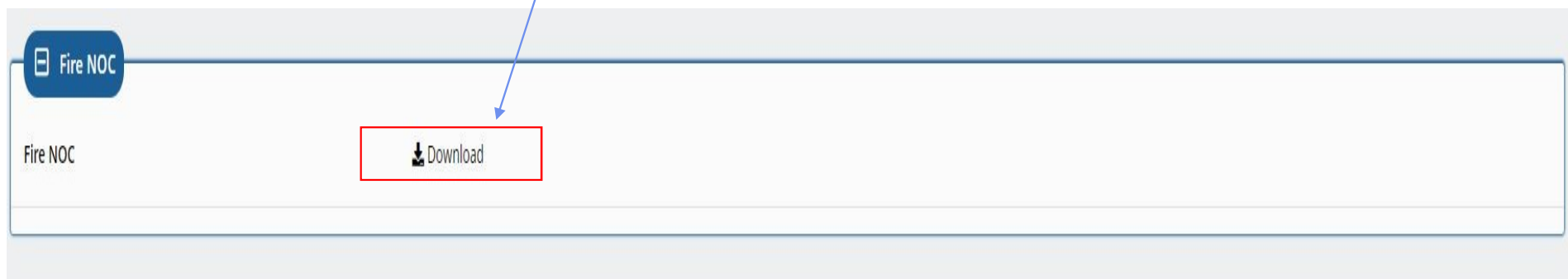

Thank you
धन्यवाद